

University Hospital Campus Plan

Community Engagement + Campus Plan

February 21, 2023

Existing Site Plan

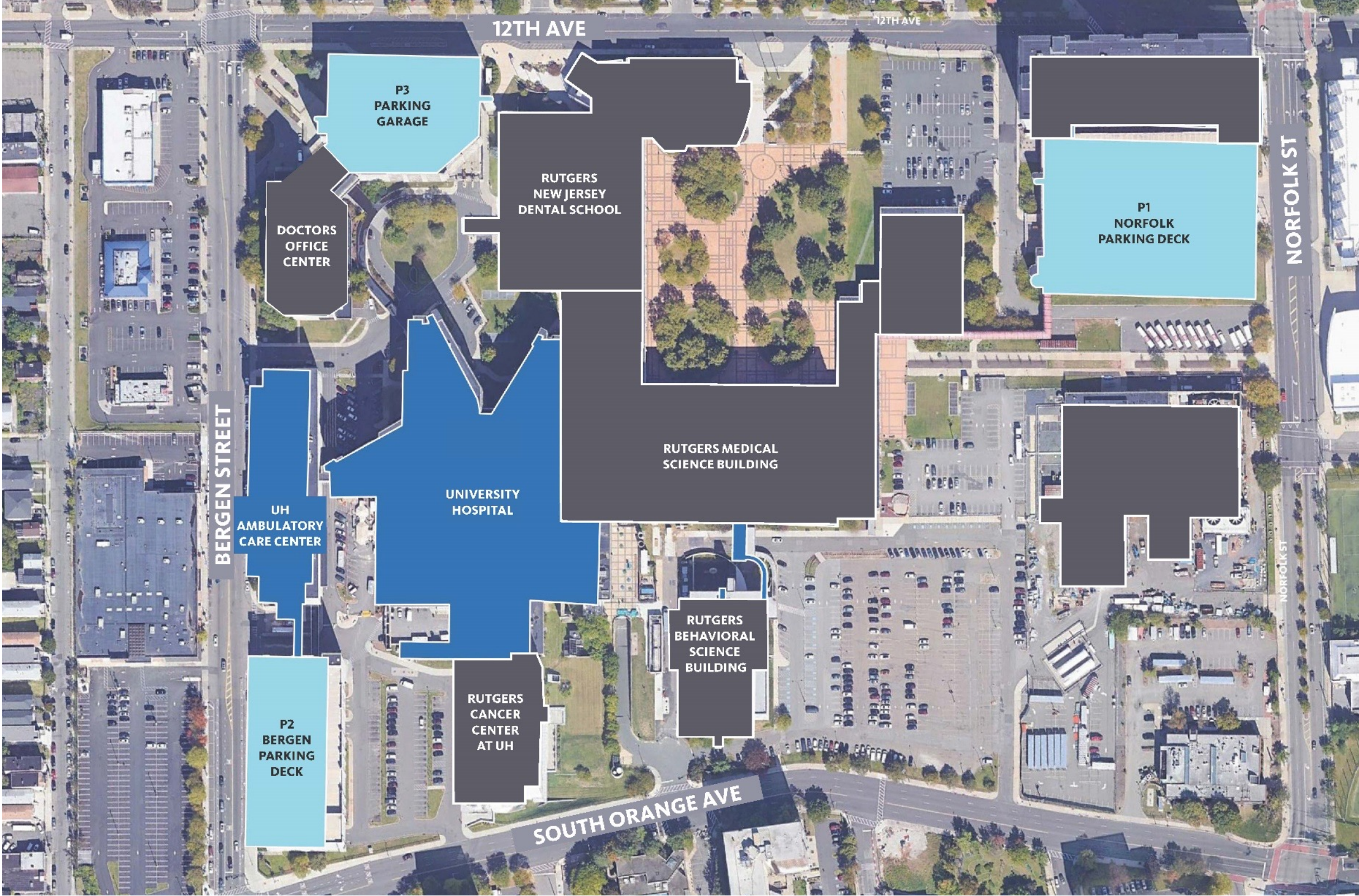

Who We Heard From

Over **500 members** of the University Hospital community shared their voices through multiple engagement channels

small group conversations | leave-behind posters | multi-lingual digital survey



The new University Hospital should ...

Foster a Sense of Safety & Trust

- Safe & accessible parking
- Well lit spaces to assure a sense of security
- Multi-lingual signage, translation, & communication
- Human-centric arrival experience
- Transparency & accountability between the community and UH leadership
- Reliable and accessible technology

Build Community & Opportunity

- Health education-based community programming
- Cultural engagement through local art, diversity training for staff, and trauma-informed practices
- Partnerships with local schools and community groups for recruitment and training
- Cultivation of a more personal employee experience through UH affinity groups, UH community spaces and employee recognition programs

Create Conditions for Health & Well-being

- Variety of indoor and outdoor multi-use green spaces for both physical and mental wellbeing
- A focus on healthy food and nutrition through educational programming & diverse food options
- Family-focused spaces for play, learning, and respite
- Health-related ground-floor retail and services with street access



A clear and safe arrival

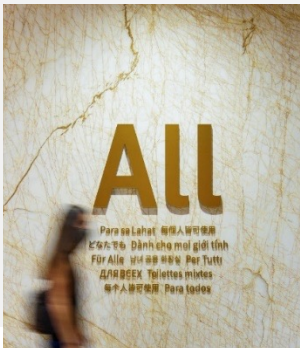

Multilingual signage



A place for secure, temporary storage



A vibrant pedestrian experience



A place for pause



A place to learn something new



A place to strengthen and stretch



A place to pick up fresh groceries



A place to take care of yourself

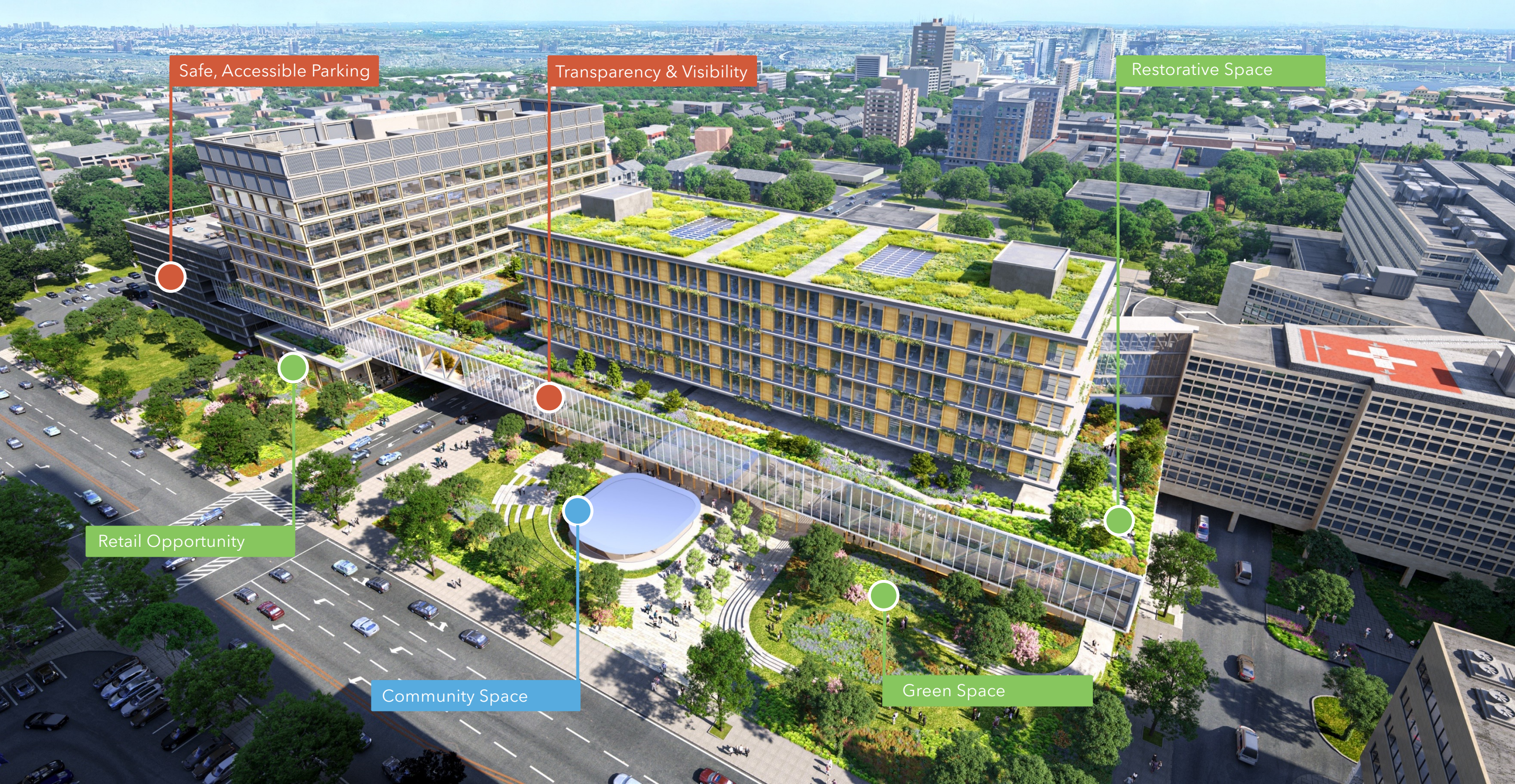

Safe, Accessible Parking

Transparency & Visibility

Restorative Space

Retail Opportunity

Community Space

Green Space











Campus Development Strategies | Draft Option

SCHEDULE FOR IMPLEMENTATION & COST ESTIMATE SUMMARY

Mostly Enabling

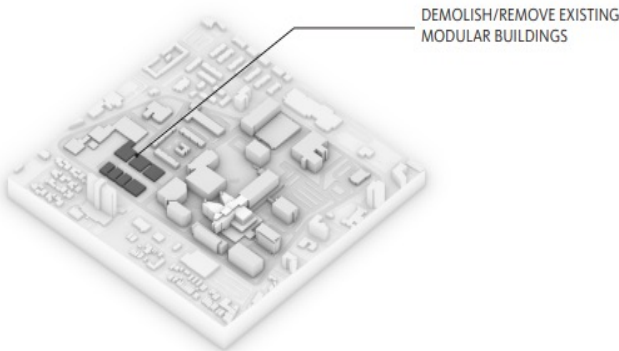

Phase 1	9 months	\$23.5m / \$31.7m
Vacate & Demolish Modular Buildings	6 months	\$5m
Prep Site for ACC, Parking & Development	3 months	\$6m
ACC & Garage Documentation+ Regulatory	Concurrent	\$6m
Exstg. Hospital Infrastructure Documentation	Concurrent	\$6m
Emergency Dept. Phase 1 Documentation	Concurrent	\$5m

9 MONTHS

Mostly Replace DOC, Parking Garage, Start ED Construction

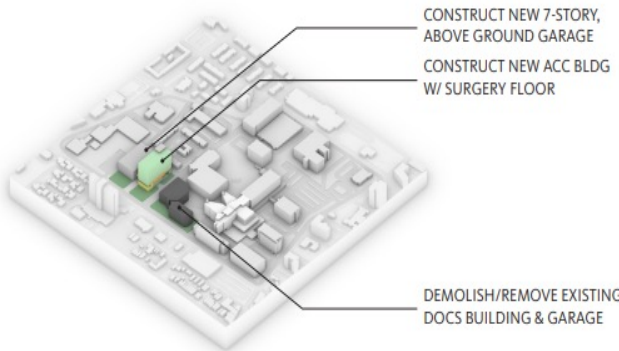

Phase 2	30 months	\$429.2 m / \$579.4m
Build ACC, Parking Garage & CUP	24 months	\$257.5m
Occupy ACC (Vacate DOC's)	Concurrent	included above
Demolish DOC's & Garage, Prep Site	6 months	\$11.7m
New Hospital Documentation+ Regulatory	Concurrent	\$25m
Exstg. Hospital Infrastructure Upgrades	Construction Concurrent	\$25m
Emergency Dept. Phase 1 Construction	Concurrent	\$25m
Escalation	Pro-Rata	\$85m

30 MONTHS

~\$610 MILLION

Mostly Build New Hospital Building

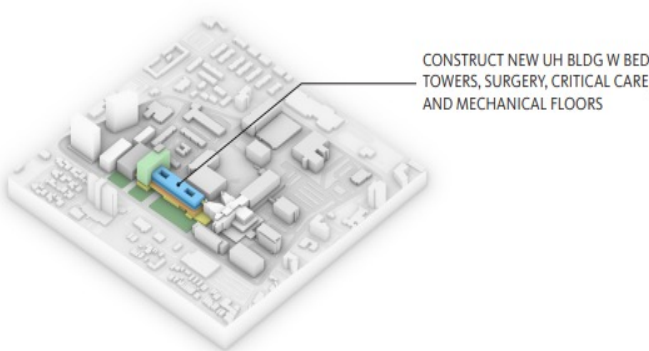

Phase 3	30 months	\$610m / \$823.5m
Build New Hospital, Links & Site	30 months	\$450 m
Occupy New Hospita	Concurrent	included above
Exstg Hospital Documentation+ Regulatory	Concurrent	\$10m
Exstg. Hospital Infrastructure Upgrades	Construction Concurrent	\$25m
Escalation	Pro-Rata	\$125m

30 MONTHS

Renovation of the Existing University Hospital

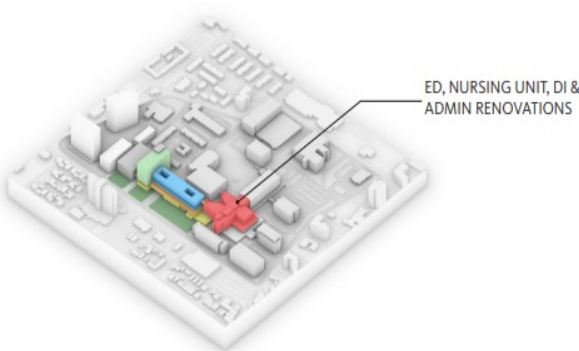

Phase 4	36 months	\$258 m / \$348.3m
Emergency Department Phases 2, 3 & 4	18 months	\$40m
Nursing Unit Renovations	18 months (+18 Concurrent)	\$165 m
DI & Adm in Renovations	Concurrent	\$10m
Occupy DI & Admin	Concurrent	included above
Escalation	Pro-Rata	\$43m

36 MONTHS

~\$1.2 BILLION

8YEARS, 9 MONTHS
\$1.80 BILLION PROJECT COST